

| # | DESCRIPTION | PART NUMBER | QTY |
|----|---|--------------|-----|
| 1 | Tubo di raccordo / Link pipe | 9773S055S2A | 1 |
| 2 | Tubo di raccordo / Link pipe | 9773S055S2B | 1 |
| 3 | dB Killer | 50.DK.081.0 | 1 |
| 4 | Silenziatore / Muffler - db killer 50.DK.142.0 | GP PRO 280 | 1 |
| 5 | Vite M8x40 / Screw M8x40 | 50.73.075.1 | 1 |
| 6 | Rondella in alluminio nera / Black aluminium washer | 50.73.221.1 | 1 |
| 7 | Dado M8 flangiato / Flanged nut M8 | 50.73.393.1 | 1 |
| 8 | Staffa / Bracket | 50.S5.1101.0 | 1 |
| 9 | Vite M8 x 16 / Screw M8 x 16 | 50.73.098.1 | 2 |
| 10 | Rondella di sicurezza / Safety washer | 50.73.604.1 | 2 |
| 11 | Gommino per molla / Rubber pipe | 50.73.210.1 | 2 |
| 12 | Molla media / Mid-size spring | 50.73.359.1 | 2 |

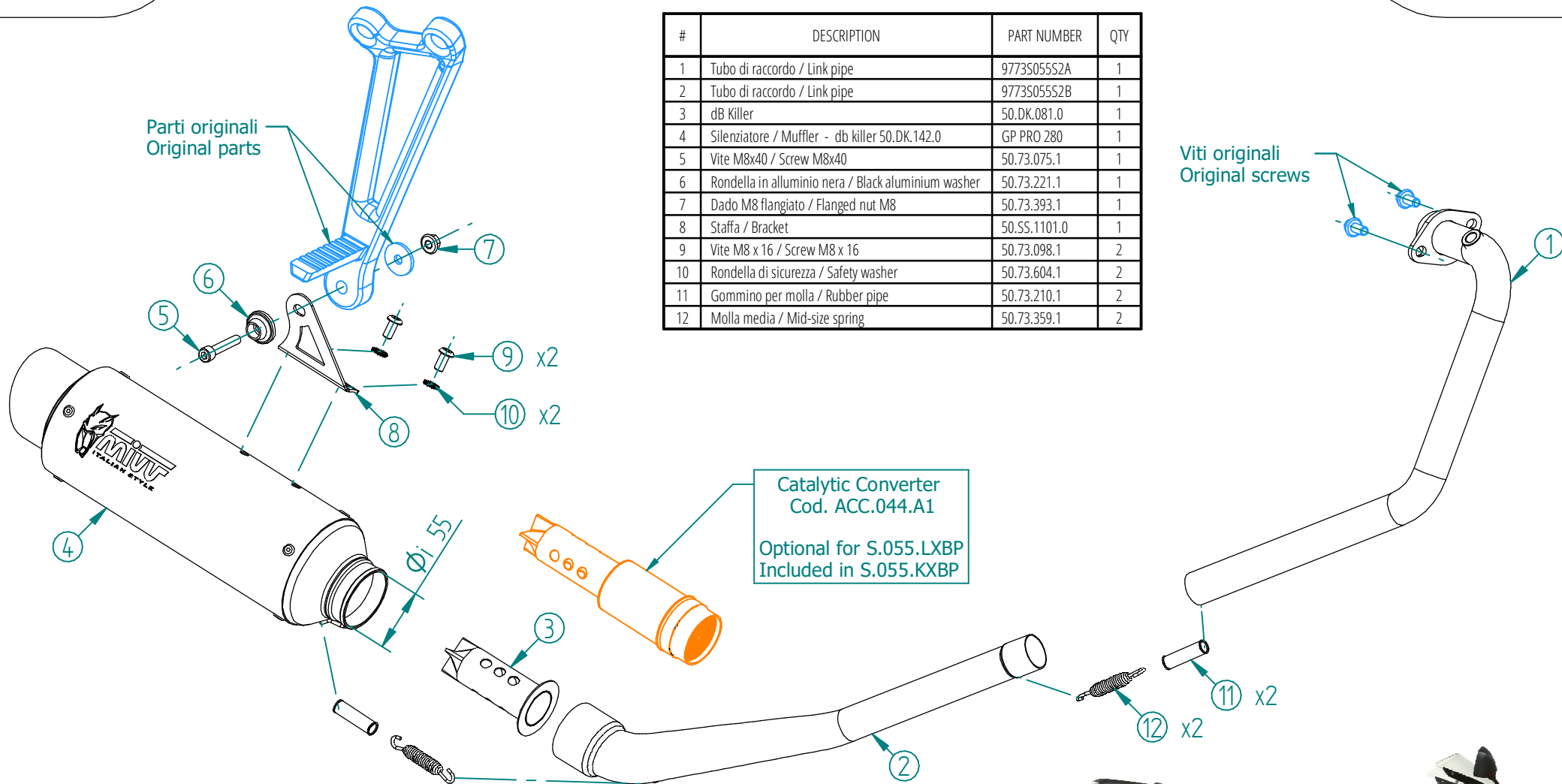

APPLICAZIONI / APPLICATIONS

| CODICE / CODE | SILENZIATORE / MUFFLER | TUBO / PIPE | NOTE |
|---------------|------------------------|------------------|----------------------------------|
| S.055.LXBP | STEEL BLACK | INOX / ST. STEEL | CATALYTIC CONVERTER NOT INCLUDED |
| S.055.KXBP | | | CATALYTIC CONVERTER INCLUDED |